

Wafas AND Wallas

YOUR LOCAL PARISH MAGAZINE

www.wavendonparishcouncil.co.uk

March 2020

Milton Keynes 2050
Public Consultation Underway



Welcome to the Spring edition of Wafas & Wallas – exciting and very positive developments anticipated by the NoExpressway campaign, progress to report on East West Rail and the consultation is underway for the Milton Keynes Council's 2050 ambitions. More inside





- Recommended Growth Option
- Intensification of existing MK Urban Area
- Strategic Green/Blue Infrastructure
- Potential route and nodes for Mass Rapid Transit Network
- Railway Station
- Potential new Railway Station
- Potential Park and Ride location
- Potential new infrastructure links and junctions
- Allocations or commitments in adopted or draft local plans



Wafas & Wallas – Your Parish Newsletter SPRING 2020 EDITION

Editor: *David Hopkins*

80 Walton Road | Wavendon | Milton Keynes | MK17 8LW

Wafas AND *Wallas*

For any local issues contact me at;

David.hopkins@milton-keynes.gov.uk

Printed & Published by
Wavendon Parish Council
on behalf of the people
of the ancient Parish of
Wavendon
(including parts of
Hog Sty End)



Wavendon on the Web:

www.wavendonparishcouncil.co.uk

**Copy Date
for June 2020**

(the Summer 2020) edition:
17 May 2020

Wavendon Parish Council

For any issues that you would like to raise
with Wavendon Parish Council please
contact, in the first instance, Parish Clerk -
Alan Kemp

Wavendon Parish Council Clerk
alanj.kemp@btinternet.com

Address

57 West End, Long Whatton,
Loughborough, Leicestershire, LE12 5DW.

Phone Contact

HOME 01509 844241

MOBILE 07783 939020

Wafas & Wallas is printed by
bespoke media 01234 720105

Village Contacts

Wavendon Parish Council



Cllr David Hopkins *(Chairman)*

Cllr Susan Moroz

Cllr Yogini Thakker

Cllr Arthur Braddish

Cllr David Ostler

Cllr Robert Hill *(Vice Chairman)*

Cllr Ron Jamieson



**Looking to hire
the Wavendon Community
Centre?**

Contact Susan Hopkins

Hall Manager:

T: 07512 685198

Interested in becoming a Parish Councillor in Wavendon?



Parish Councillors are elected representatives who volunteer their time freely to work on behalf of local residents. Individuals may also be co-opted at the discretion of the council if there is a vacancy.

By becoming a parish councillor you can become a **VOICE FOR OUR COMMUNITY, SOMEBODY WHO RESIDENTS WILL LOOK TO FOR HELP, GUIDANCE AND SUPPORT.**

You will be involved in local decision making and strategic planning for the benefit of the people you serve. Seeing your community change for the better, as a result of decisions you have helped make, is something that can give you a sense of achievement and pride.

Eligibility for Parish Councillor (one of the following):

- (a)** is registered as a local government elector for the parish; or
- (b)** has during the whole of the preceding twelve months occupied as owner or tenant, any land or premises in the parish; or
- (c)** his/her principal or only place of work during the preceding twelve months has been in the parish; or
- (d)** had during the whole of the preceding twelve months resided in the parish or within 4.8 km thereof.

INTERESTED THEN CONTACT:

Alan Kemp the Parish Clerk by post at
57 West End, Long Whatton, Loughborough, Leicestershire, LE12 5DW

or via the telephone on **01509 844241**
The Parish Council can also be contacted by email at;
alanj.kemp@btinternet.com

Could you deliver Wafas & Wallas in your street?

LET THE EDITOR KNOW BY EMAILING;

David.hopkins@milton-keynes.gov.uk

... if you could deliver four times a year and help keep our community informed.

Bletchley to Bedford Rail Update



THE FIRST DIRECT RAIL LINK IN MORE THAN 50 YEARS BETWEEN OXFORD, BEDFORD, MILTON KEYNES AND AYLESBURY HAS BEEN GIVEN THE GREEN LIGHT FOR FURTHER WORK.

Today (Tuesday 4 February) the Secretary of State for Transport approved Network Rail's Transport and Works Act Order application, granting permission for work to begin on the next phase of East West Rail.

Once complete, phase 2 of East West Rail would connect communities and businesses between Oxford and Bedford, and Milton Keynes and Aylesbury, with:

Two trains per hour each way between Oxford and Milton Keynes

One train per hour each way between Oxford and Bedford

One train per hour each way between Milton Keynes and Aylesbury

The new railway will also connect the Great Western main line, Chiltern main line, West Coast main line and Midland main line – providing passengers with much-improved cross-country rail links from East to West.

This would help create jobs, boost economic growth, encourage people out of their cars and onto public transport and enable sustainable housing development for generations to come.

Tim Shoveller, managing director for Network Rail's North West & Central Region, said: *"Building a new railway would transform connectivity and journey times across the heart of the country. East West Rail promises to provide a greener, low carbon transport system which will bring huge benefits to passengers and businesses – driving economic growth and*

creating opportunities for housing and new jobs."

Cllr Mark Shaw, chairman of the East West Rail Consortium, an alliance of local authorities which produced the original business case for the scheme, said: *"This has to go down as one of the most exciting weeks in the history of East West Rail, with approval to begin major construction of the Western section coming just days after the preferred route between Bedford and Cambridge was announced. East West Rail will transform the way people travel within and across the region, supporting communities, boosting businesses, unlocking job opportunities, and getting people out of their cars. The Consortium and the local authorities along the line will continue to work with Network Rail and its partners to ensure the western section is now delivered as quickly and smoothly as possible."*

With phase 1 between Oxford and Bicester already complete, phase 2 involves track and signalling upgrades between Bicester, Bedford, Aylesbury and Milton Keynes, including reinstating a disused section of railway between Bletchley and Claydon Junction, north of Aylesbury Vale Parkway.

The work will deliver significant improvements to local travel, with the phased introduction of new rail journeys between:

Oxford and Milton Keynes: with trains stopping at Oxford Parkway, Bicester, Winslow and Bletchley.

Oxford and Bedford: with trains stopping at Oxford Parkway, Bicester, Winslow, Bletchley, Woburn Sands and Ridgmont.

Milton Keynes and Aylesbury: with trains stopping at Bletchley, Winslow and Aylesbury Vale Parkway.

The East West Rail project is planned to be built progressively in phases, and once constructed would create a world-class rail link connecting Oxford, Bicester, Milton Keynes, Bedford and Cambridge.

For more information you can visit:
www.networkrail.co.uk/east-west-rail/

Expressway

<https://www.noexpressway.org/>

We believe there is no need for an Oxford-Cambridge Expressway, nor the over-inflated housing targets associated with it, and we will actively campaign against it and support other organisations with the same objectives.

Our environment is a national asset which should be protected for all us, our health and well-being. This is a national and not just a local issue.

We strive to educate people about the threats to our countryside posed by the planned Expressway and its associated housing and development.

We support new housing of the right kind and in the right location, but not growth in Oxon of greater than 100% and Bucks and Milton Keynes of 87% by 2050. We will fight to protect our countryside and its wildlife for the health and enjoyment of all future generations.

The No Expressway Group is a non-political community group which was started in Horton-cum-Studley in March 2018. The group was formed to fight the proposed Oxford to Cambridge Expressway that threatened to cross parts of Oxfordshire and Bucks and more recently Wavendon, Woburn Sands and surrounding communities in Milton Keynes.

We believe local groups are most effective at mobilising their local communities, but by working together we can run a stronger campaign.

Contact the No Expressway Group at
noexpresswaygroup@gmail.com



Marshall Aerospace possible move to Cranfield



Cambridge industrial behemoth Marshall Aerospace and Defence Group has ditched IWM Duxford from a shortlist of three potential new UK locations.

It leaves a straight choice between Cranfield and RAF Wyton in St Ives for a new HQ – and the Bedfordshire site would appear to be vastly superior, in terms of facilities and required investment spend. A decision will be taken as soon as possible this year.

The only significant factor Wyton would appear to have in its favour is that so many of Marshall ADG's 1500 staff live in north Cambridgeshire so travel to work tyreprint would be reduced if Marshall cold-shouldered Cranfield, which is around 38 miles away. But Wyton has already been deemed inadequate once before – back in April 2010.

IWM Duxford was named as a potential relocation option for the business when it announced its intention to move out of Cambridge by 2030. But after uncovering a number of insurmountable issues, both Marshall Aerospace and Defence Group and Imperial War Museums have now reluctantly agreed IWM Duxford is no longer a feasible option.

Marshall Aerospace and Defence Group CEO, Alistair McPhee, said: "We had identified an area of land at IWM Duxford situated to the far South-West of the existing airfield that did not impact areas of historical interest or require complex infrastructure upgrades."

Waste Recycling bags

MKC still provide these free to residents but no longer deliver them automatically every so often to houses. *Instead you need to either go on line to **MKC website** and **register**, or ring **01908 252570** to order more.*





Our January working party met in Phoebe Lane to solve a problem. The new houses storm water together with the drainage from the recreation ground was causing a problem in the lane with large deep puddles and running water damaging the unmade road surface. The ditches and gullies were completely blocked and needed a

major overhaul. The team split into groups and dug out the ditch, cleared the gully and started to clear the ditch running from the recreation ground.

The photos show after the ditch was cleared on Phoebe Lane. Only some of the team in the photo. A job well

done especially considering the recent weather and storms. More to do but already conditions in the lane have dramatically improved.

If you would like to join us contact us at japthm@outlook.com or see our Facebook page at **Wavendon Volunteer Army**.

Emergency Planning

In the event of an incident **999** is the number to call if human welfare is at risk.

The **MKC out of hours emergency** number is **01908 226699** and can be called where MKC assistance is required and MK Council has a Duty Emergency Planning Response Officer on Duty.

During Office Hours call Emergency Planning on **01908 254555**

Alternatively residents should call the Councils normal switchboard number **01908 691691**

1940S TEA DANCE

FRIDAY 8TH MAY 2 - 4PM

WAVENDON COMMUNITY CENTRE

There will be a short Act of Thanksgiving for VE Day at The War Memorial at 1.45pm. Do join us.



Buy your tickets at St. Marys Church or email alisetrendall@gmail.com
All proceeds to The Royal British Legion

Major New School Announcement for Glebe Farm



An 'All through' school (which caters for children from reception through to Year 11) has been given the go-ahead at Glebe Farm in South-East Milton Keynes.

The school will provide places for up to 1,530 pupils from reception to Year 11 plus provision for a 39 place full-time equivalent (FTE) nursery.

The new school is expected to be open from **September 2022** in several phases according to local demand.

Development of the school will take place on a 95,000m² site - an area larger than 13 football pitches, off Burney Drive in Glebe Farm. This will include sports facilities such as an artificial grass pitch which will be made available to the local community.

The school will be open to families living in Glebe Farm for children in Year R to Year 6 and a wider catchment - Glebe Farm, Eagle Farm, Woburn Sands and Wavendon Village for children in Year 7 to Year 11. The new school will cost approximately £29m and will be funded from a combination of Basic Need Government funding, Section 106 grant funding and council borrowing. This budget includes the sports facilities and a 39 place FTE nursery. The design and planning phase is due to commence in March with construction starting in January 2021.

Since 2014, five new schools and 16 school expansion projects have supported an increase of 2,300 pupils in Milton Keynes. By 2026, it is expected that the population of Milton Keynes will have risen by 40,000 to almost 300,000. Milton Keynes Council has committed to ensuring there is a good school place ready for every child.

FURTHER INFORMATION ABOUT WHO WILL RUN THE SCHOOL WILL BE AVAILABLE LATER IN THE SPRING.



Wafandun Lane
Wavendon
Milton Keynes
MK17 7AA

Headteacher Mrs A Dicks
office@stmaryswavendon.milton-keynes.sch.uk
01908 582182

We are growing!

At St Mary's Wavendon CE Primary we are now rapidly moving towards 100+ pupils within our school as the new Eagle Farm development is expanding. From September 2020 (subject to consultation agreement with MK Council) St Mary's will be offering nursery provision for children aged 3 to 4. If you have a child who was born between 1st September 2016 and 31st August 2017 then please contact us if you are interested in applying for a possible place for September.

It is likely we shall offer the following options:

15 hours universal provision (Monday to Friday) am or pm sessions

30 hour provision (Monday to Friday 8.30am – 2.30pm) and staying over lunchtime (packed lunch provided by parents)

30 hour provision (Monday to Friday 8.30am – 3.30pm, but buying an extra hour at the end of the day from 2.30pm to 3.30pm)

It is not expected that our nursery children will access either breakfast club or after school club.

Please note that you are only registering your interest at this stage as all applications are subject to our nursery consultation being successful.

We look forward to hearing from you!



Speed Reduction Plan

Please note that the website at MK Council is now live and accepting applications for 20mph speed limits:

<https://www.milton-keynes.gov.uk/highways-and-transport-hub/road-safety/introduction-of-20-mph-speed-limits-into-residential-areas>



"My dear friends, this is your hour."

Winston Churchill on VE Day.

When VE Day dawns on 8th May 2020 it will be 75 years since the guns fell silent at the end of the war in Europe. Years of carnage and destruction had come to an end and millions of people took to the streets and pubs to celebrate peace, mourn their loved – ones and to hope for the future, but not forgetting those still in conflict until 15th August when it was announced that Japan had surrendered unconditionally to the Allies, effectively ending World War II.

The 75th anniversary will provide our nation, and our friends around the world, with an opportunity to reflect on the enormous sacrifice, courage and determination of people from all walks of life who saw us through this dark and terrifying period. To commemorate this important time we are organising VE Day 75, a three-day international celebration that will take place from 8th May to 10th May 2020

Get involved in VE day 75

COME & TRY GIRLS' FOOTBALL

Girls' football is growing at a phenomenal rate, but nowhere more so than right here in Wavendon!

Woburn & Wavendon FC has one of the country's largest number of grassroots football teams. In fact the club has an all-girl team at every age group from under 8 through to adult women.

Long before the Lionesses of the England Womens' team were capturing the nation's attention, WWFC's Lionesses were thriving with a number of teams playing regular matches. Today the Club has eleven teams with five of the youngest groups playing in Wavendon. Wavendon Recreation Ground and the new St Marys C of E Primary School playing fields at Eagle Farm provide excellent venues for the girls to make the most of all the FUN and FRIENDSHIP football can provide.

And now's the best time for 6-11 year olds to come and try girls' football for the first time.

From Sunday 1st March and then every Sunday through to July 12th, the Club will be delivering the FA backed Wildcats Football Centre, enabling local girls to sample all the excitement of organised football.

The sessions commence at Fulbrook Middle School in Woburn Sands and then move on to grass at Woburn Village Playing Fields later. Last year there were more

than sixty participants – one of the largest attendances in England! WWFC also holds one of the UK's largest girls' football tournaments in June, with nearly 150 teams attending over two days at Woburn. This will also offer opportunities for Wildcats teams to take part in all the fun.

To find out more/enrol for Wildcats, please email:-
Wildcats@ww-fc.co.uk



Menday Gardens

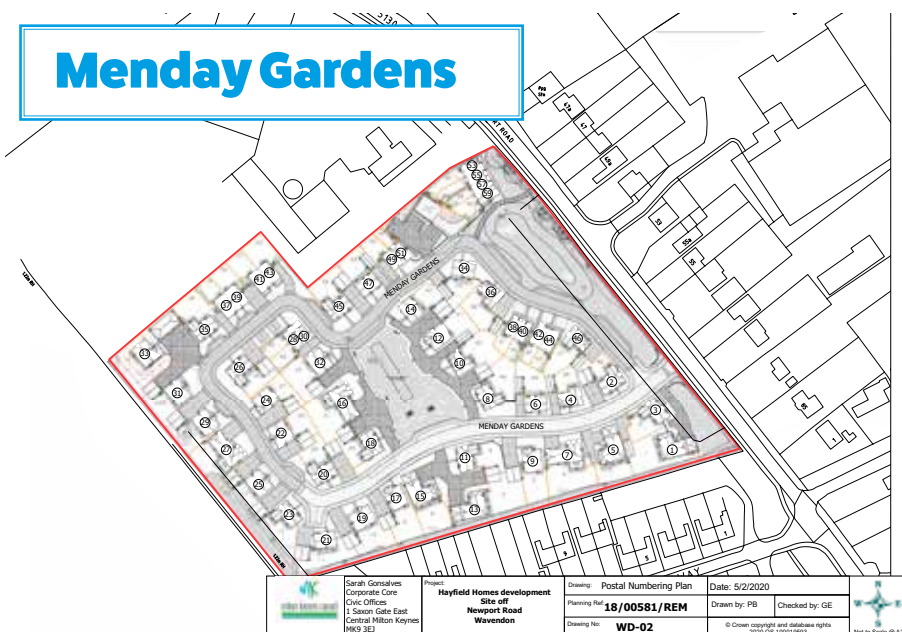

Work is about to commence on the site now known as **MENDAY GARDENS** (formally Wain Close) off Newport Rd. See site layout above.

Tennis Court Provision

WITH OPTION FOR OTHER SPORTS

WAVENDON RECREATION GROUND/FORMER ST MARY'S PRIMARY SCHOOL SITE



Background

Wavendon Parish Council has taken responsibility for the former St Marys Church of England Primary School site at Walton Road, Wavendon since the school relocated. Part of the facility includes the school's former all-weather MUGA playing surface.

Wavendon Parish Council undertook a consultation process with the community for the future leisure facilities they would like to see provided. Tennis provision featured highly in responses.

Wavendon Parish Council has participated in City wide Tennis provision discussions. MK Council, Bucks Tennis and the LTA have all identified a shortage of Pay & Play tennis provision across MK.

Milton Keynes Playing Pitch Strategy consultation is expected to confirm that the Wavendon and surrounding area is a "cold spot" for the provision of artificial all-weather playing surfaces.

The future expansion of Wavendon (current population under 400 with anticipated future growth to nearly 4000) as well as other local parishes and towns means we have to deliver facilities and activities to engage and integrate both the existing and new populations. Part of this must facilitate community activities to reduce obesity, improve mental health/well-being, and encourage healthy social interaction and a sense of community.

Proposal for the re-development of the MUGA.

Public Meeting

MK 2050 – PUBLIC MEETING

A strategy for the future of Milton Keynes will only succeed if it is created together with all its communities. MK Council officers have produced a draft Strategy for 2050 to encourage people to get involved in a discussion about one proposed approach - which has been developed from the work of the MK Futures 2050 Commission (published in 2016). You can access the current consultation strategy at <https://www.mkfutures2050.com/strategy-for-2050-engagement-page>

Woburn Sands Town Council together with Ward Councillor David Hopkins, has invited Strategic Planning Officers from MK Council to present their vision of MK2050 at a Public Meeting in the Memorial Hall (4 High Street), Woburn Sands on **Thursday 26th March starting at 7.30 pm.**

The meeting will be chaired by Cllr David Hopkins.

This is your opportunity to hear first-hand what might be being planned and to ask questions of the Strategic Economic Growth and Planning Experts present.

Please share your views with MK Council officers on what you've heard and read. You can get in touch with them at...

by email, to
MKFutures@milton-keynes.gov.uk

The MUGA is located with access from Wavendon Recreation Ground, and existing changing room and car parking facilities.

By re-developing and enlarging the existing MUGA, new three court tennis provision can be delivered. Advice has been sort from the LTA and this is their minimum recommendation.

LET WAVENDON BE Green

THE EARTH'S CLIMATE IS CHANGING

Global temperatures are projected to continue rising, bringing changes in weather patterns, rising sea levels and increased frequency and intensity of extreme weather for the UK.

The extent of change will depend on how we all cut our greenhouse gas emissions and how we prepare. The impacts of climate change will vary from place to place meaning that action at the local and regional level is vitally important to help reduce the risks.

We as the Parish Council aim to work with the local council and community groups, to take action to adapt to climate change, using the information we have about some of the future risks to provide guidance and some practical examples of action that can make a difference to us all.

STEPS THE PARISH COUNCIL CAN TAKE IN THE FUTURE

Encourage the formation of Climate Action groups • Support planning applications for new renewable energy in the area • Bring together groups of people to make bulk purchases • Manage land for nature and increase tree cover • Neighbourhood planning

STEPS ALL OF US IN WAVENDON CAN TAKE NOW

Buy green • Develop and promote a lift-sharing scheme • Reduce pesticide use in your garden • Produce green energy - Buy solar panels • Minimise waste going into landfill - recycle efficiently

The Parish Council plans to create steering groups and create a robust plan, taking full account of the environment and its value to people and wildlife, through the creation of a Community-level green Infrastructure Plan.

A robust plan – takes full account of local greenspace, biodiversity, historic environment, access and landscape issues and helps shape the future of local communities, ensuring the environment is protected and enhanced.

The Parish Council will also use their local knowledge to input and advise every step of the way so that local priorities always reflect the needs of all of our community, and this can then underpin the foundations for our environment policies for the future.

BY THE 2080's WE COULD SEE:

Average summer temperature increases in the South East of England, of 3.9°C within our children's lifetimes (by the 2080s).

A 23% decrease in average summer rainfall in the S. East by the 2080s.

Adapting to climate change means changing the way we do things – in all areas of our lives.

SOME OF THE WAYS ACTION CAN BE TAKEN

Parks and open spaces: Demand these is likely to increase with warmer winters and hotter drier summers. There are likely to be a number of social, health and environmental benefits in acting now to create well shaded green spaces and community woodland areas.

Renewable energy production: It may be possible to use producers such as wind and water power.

ACTION PLANNING

We can set up an action group to tackle local climate issues, share information and/or be a contact/information point for residents. They could also work to demonstrate many of the values of a Community Led Plan (self-help, empowerment, done by the community for the community).

- **Planting:** Manage land, verges and flower displays using drought-resistant plants and shrubs that look good and need less watering. These will be more resistant to extreme weather conditions caused by climate change such as droughts and floods. Also, use permeable surfacing in all public spaces to improve natural drainage and prevent flooding risks.
- **Waste:** Work with the local authority to provide as many recycling services as possible and ensure that waste contractors take into account warmer and windier conditions in the design and management of waste sites, to help control odours and vermin.
- **Sustainable transport:** Help to ensure that cycle paths, bus shelters, roadside seating and services are provided and well maintained to encourage community usage and reduce car dependency. Also, promote car sharing and offer incentives (e.g. allocate prime parking spaces or air pollution, which may be exacerbated in increased summer temperatures).

The Government has a comprehensive plan for tackling climate change which has five elements:

- **Protecting the public from immediate risk**
- **Preparing for the future**
- **Securing a global deal**
- **Supporting individuals and businesses to play their part.**
- **Creating a low carbon UK**

The key outcomes and benefits: Residents come together in local groups to share ideas and take action. The programme of activities is designed to meet objectives of raising awareness of individual responsibility, in saving energy and reducing carbon in Wavendon and the surrounding area.

Community woodland: Careful planning of species of trees and plants to ensure adaptation to warmer climate and potential for drought.

School for the Future - Central Bedfordshire Council

WOBURN SANDS AND SURROUNDING VILLAGES IN CENTRAL BEDFORDSHIRE

There are currently six schools in Woburn Sands and the surrounding villages; five lower schools, with pupils moving on into one middle school (Fulbrook).

This is known as the Fulbrook pyramid. These schools are a mixture of council-maintained schools and academies (which are independent of the council).

The table below shows the schools included in this area and their current school type and capacity.

When pupils leave Fulbrook Middle School, they go on to upper schools and in the main they attend those in the Leighton Linlade area.

School name	Current school type	Current school capacity
Aspley Guise	Lower	135 pupils
Swallowfield	Lower	290 pupils
Husborne Crawley *	Lower	60 pupils
Ridgmont*	Lower	75 pupils
Woburn*	Lower	60 pupils
Fulbrook	Middle	440 pupils

**These three lower schools are very small, with the total intake of pupils last September for all three schools being just 20 pupils*

Demand for new school places

Whilst there is some housing development planned near Woburn Sands this is in Milton Keynes area and Milton Keynes Council are planning to meet this demand for these new school places.

In Leighton Linlade there are approximately 3,352 new homes planned over the next 15 years or so. These new homes mean we will need around 3,000 new school places. So, we are working with the schools in the Leighton Linlade area to plan for more school places and we will consult on proposed changes to schools in Leighton Linlade later in the year.

More immediately we are proposing to change the schools in Woburn Sands and the surrounding area (Fulbrook pyramid) to provide parents and pupils with more choice and the option to attend school closer to where they live rather than traveling to Leighton Linlade. These proposals will also help the schools in Leighton Linlade accommodate some of the increased demand from the new homes in that area.

Central Bedfordshire Council has developed a draft

plan which will deliver the following changes between 2022 and 2024:

- Swallowfield and Aspley Guise lower schools to become primary schools in 2022, so pupils will join at reception and continue at the schools until the end of Year 6

- Fulbrook Middle School to become an extended secondary school in 2022, so pupils can join the school at Year 5 or Year 7 and continue there until the end of Year 11. The school will become a secondary school in 2024 when pupils in Year 5 will stay in their primary schools

- Husborne Crawley, Ridgmont and Woburn lower schools are to work together as soon as possible as a federation with the goal of coming together as a single primary school on one site. Options for the site for the new school are still being explored at this stage but is anticipated that this will happen in 2024. Until 2024 all three schools will remain open on their current sites and pupils will continue to transfer to Fulbrook at Year 5.

The majority of the schools in Woburn Sands and the surrounding villages want to take this opportunity to move to the primary/secondary school model and, in fact, Fulbrook Middle School have already consulted on changing their age range.

While this is a significant change, it's a positive move that means we will be able to continue to provide a great education for pupils in the future in our own locality as well as increase the capacity of the schools, allowing them to grow and accommodate more pupils.

The changes also provide an opportunity to increase Special Educational Needs and Disability (SEND) services in local schools.

How to have your say

The future of our education system in Woburn Sands and surrounding villages matters to our whole community, for current or future generations of children and young people, and everyone who has an interest is invited to give their views on the proposals for change.

You can have your say by completing our questionnaire or you can pick up a paper copy from your local school.

The consultation is open from 22 January 2020 to 5pm on 15 April 2020

More at <https://www.schoolsforthefuture.co.uk/>

Waste Collection

POSSIBLE NEW ARRANGEMENTS - PILOT

Driven by Milton Keynes Council's ambition to become the Greenest City and the Sustainability Strategy 2019-2050.



The Environmental Services Programme is reviewing its future service provision, which includes waste collection. A motion was put forward to Full Council on 17 July 2019, which was referred to Cabinet on 3 September 2019, to explore pilot schemes for waste collection to replace the use of plastic sacks. This included the use of wheeled bins and other waste management solutions that could address the different challenges faced by different estates. A revised collection system is required to be tested before a borough wide roll out, to collect data, to review the modelling, operational methods and evaluate resident feedback. The pilot will measure: ease of use; recycling rate, contamination, carbon management and resident satisfaction.

It is proposed that the waste collection pilot will include 5,800 properties and will run for at least a six month trial period. The pilot will consider the effectiveness and practicality of introducing a new waste collection method as an alternative to plastic sacks to residents. This will be tested before decisions are taken for the design and delivery of waste collection in 2023 when the existing waste collection contract expires.

Full details can be found within the Delegated Decision report, which will be considered on the 11 February;

Contact for more information - **Penny Fletcher**
Community Engagement Manager
Environment and Waste
Direct: **+44 (0)1908 258063**

Milton Keynes Council | Environment & Property |
Environment & Waste Team | Milton Keynes Waste Recovery Park
| 9 Dickens Road | Old Wolverton | Milton Keynes | MK12 5QF

Visit us online: www.milton-keynes.gov.uk
Follow us on Twitter: [@mkcouncil](https://twitter.com/mkcouncil)

Twenty's Plenty



Petitions have been submitted to MK Council demonstrating community support for the proposed speed limits. The reduction in the speed limit will encourage a safer environment for motorists, pedestrians and cyclists.

Speed counts taken in October 2019 show that the mean speeds on the affected lengths of road are below 24mph. Petitions have been submitted to MK Council demonstrating community support for the proposed speed limits.

The reduction in the speed limit will encourage a safer environment for motorists, pedestrians and cyclists.

In order for MK Council to introduce the above proposed speed limits, it must first make a traffic regulation Order. This is a legal document which allows the Highways Authority (MK Council) to restrict the highway which is enforceable by law.

MK Council is now carrying out statutory consultation on the proposed traffic regulation Order and therefore invites you to formally comment on the proposals.

Name of Street	Location	Distance
Chapel Street	Woburn Sands	Its entire length
High Street	Woburn Sands	Its entire length
Wood Street	Woburn Sands	Its entire length
Theydon Avenue	Woburn Sands	Its entire length



Climate Emergency

CLlr David Hopkins proposed resolutions regarding the Climate Emergency at the January and February meetings of Woburn Sands Town Council and Wavendon Parish Council. These were agreed unanimously by both Councils.

The impacts of climate breakdown are already causing serious damage around the world. The Special Report on Global Warming of 1.5°C, published by the Intergovernmental Panel on Climate Change in October 2018;

(a) describes the enormous harm that a 2°C average rise in global temperatures is likely to cause compared with a 1.5°C rise, and

(b) confirms that limiting Global Warming to 1.5°C may still be possible with ambitious action from national and sub-national authorities, civil society and the private sector.

If the world is to stay within 1.5°C rise, developed countries like the UK need to cut emissions faster than poorer countries and achieve net-zero carbon by 2030. Strong policies to cut emissions also have associated health, wellbeing and economic benefits.

In response to the climate threat, it is suggested that Wavendon and Woburn Sands Town Councils also declare a climate emergency and commit to making the Council's activities net zero carbon by 2030. Below are examples of the work that the council could be doing in response to this.

Pledge to go **single use plastic free** – stopped using single use plastic items ourselves

- Introduced **secure bike lockers** in the town
- Purchase or obtain through grant the towns first **electric vehicle charging station(s)**
- Require that contractors use **electric hand-held tools** (hedge trimmers, strimmers) and also require that they (over time and as appropriate) replace petrol powered tools with electrical versions
- Introduce a **FREE** water refill points along the High Street and/or recreation ground(s)
- Recycling facilities** on Parish or Town Council owned / controlled land
- Utilising **biomass boiler technology** as and where appropriate
- Smart metering** installed on the town council electricity supplies
- Working with MKC, **LED lighting** installed
- Low Carbon Milton Keynes Council - is preparing

an initial draft study report into the carbon footprint of the operation of its key assets, transport and other governance operations, and WSTC could work with MKC to provide an outline (local) plan to achieve **zero carbon operations**

•Approached organisations / individuals to undertake a comprehensive study and report across the whole of the Council's activities, which would provide qualitative measures of the impact of those activities, and overall aggregate measures of the total impact of the Council's activities and considers **climate mitigation measures**

•The substantial number of High Street catering, retail and other outlets should be requested to meet the requirements of a **sustainability** (including single use plastics) **assessment** and should be required to undertake an ongoing commitment to work with Wavendon Parish and Woburn Sands Town Councils to introduce further measures as and when practicable

•Encourage all community groups and organisation that we support to think about and **address** their **input impact on climate change** and offer support to help them meet their goals

•Set, as soon as possible, annual targets for quantitative measures of climate impact on all the **Council's activities** for the next 10 years which in aggregate amount to meeting the Milton Keynes target of net zero carbon by 2030

•Ensure that all **planning comments to Milton Keynes Council are consistent with a shift to net-zero carbon by 2030**

•Make decisions that **discourage fossil fuel car use**, redirect resources into electric vehicles, encourage walking, cycling provision and improved local rail and bus services, and supports projects that help ensure that all Wavendon & Woburn Sands residents can travel to work and education, and access services in an environmentally friendly way

•Ensure that all policy papers submitted to the Parish and Town Council and its Sub Committees include a Climate Change Impact Assessment paragraph

•**Engage with all relevant local agencies and partners**, including Milton Keynes Council, to help deliver these goals through all relevant strategies, plans and shared resources and send representatives to attend any meetings, events and partner workshops as appropriate

•Call on the UK Government to provide the powers, resources and help with funding to make this possible, and lobby local the local MP to do likewise.



Rough Sleeping Factsheet

Our commitment

To end rough sleeping in MK by 2021.

What we're doing to help

There's a lot of work going on behind the scenes to support rough sleepers, including our Housing First scheme where people are offered a home while we work with them on the usually complex reasons they became homeless.

Offering settled accommodation as the automatic first step, rather than trying to help someone overcome other issues before they're offered a tenancy, makes a huge difference for people who have been through repeated instances of homelessness.

The scheme is open to all adults who are based in Milton Keynes - have a local connection and eligible to access public funds.

More than 130 people have been supported into Housing First so far.

The Milton Keynes Homelessness Partnership (MKHP) has launched a campaign in partnership with the Council to reduce homelessness.

MKHP is encouraging people to use tap to donate kiosks located across Central Milton Keynes, including at Intu, rather than giving to beggars.



Worried about someone?

Rough sleeping goes hand in hand with underlying health and welfare issues. Our outreach team is in regular contact with rough sleepers in MK, offering advice and support, and keeping a caring eye on how people are doing, even when they've refused an offer of accommodation.

The team goes out regularly to help rough sleepers, encouraging people to take up what's on offer or to come to a local day centre to get warm, have food and a hot drink, a shower, and link in with other services.

If you're concerned about someone on the streets, please signpost them to –

- visit Civic in CMK (next to the library)
- call 01908 253481, email the team on
- outreachreferralsmk@smartcjs.org.uk or make a report to www.streetlink.org.uk (a member of the outreach team will visit them quickly to see how we can best help)

We've contributed to and supported 3,500 extra nights at the Winter Night Shelter, the re-development of the YMCA, the opening and running of Unity Park Station (one-stop shop) and the Bus Shelter MK. We've also helped with the development of health outreach services for rough sleepers.

There are a number of other rough sleeper services provided by the Council and our partners including a homelessness hub that provides accommodation and support to prevent a first night out on the streets, and additional support over the winter months including our severe weather emergency protocol (SWEP).



We need to talk about parking

We've all been there, when you can't get into the last space because of someone's poor parking, or the pavement isn't big enough for a pushchair or a wheelchair to get through because someone's parked outside the takeaway to pick up their order.

Frustrating? Yes

Illegal? Not necessarily...

We receive over 15,000 calls each year related to parking but a huge 60% of these are not matters for the police. In fact, in most areas of the Thames Valley, illegal parking is enforced by the local councils.

So, do you know when parking is illegal and when it's just inconsiderate?

Parking should be reported to police when a vehicle is parked:

- on zig zag lines or a pedestrian crossing
- in a way that would prevent emergency vehicles from access
- dangerously

Parking is illegal and should be reported to your local council when a vehicle is parked:

- opposite or within ten metres of a junction
- over a dropped kerb
- in spaces reserved for Blue Badge holders, residents or motorbikes (unless entitled to do so)
- in marked taxi bays, cycle lanes or red lines
- near a school entrance, bus or tram stop
- on double yellow lines

If the parking does not fall within those parameters, then it is classed as inconsiderate and is a civil matter and is for you to arrange with neighbours or your management company, or failing that, speak to your local council.

If a vehicle is parked on the kerb, these incidents are dealt with on a case by case basis. On some streets, parking on the kerb is unavoidable and so neither the police nor the council would intervene. In some cases, parking on the kerb could restrict access for those who are vulnerable or who have disabilities and so we would attend

If someone parks on your driveway without your permission, this is trespassing and is a civil dispute so does not need to be reported to the police or the council. If a polite word with the driver does not resolve the situation, you may wish to seek advice from Citizen's Advice External Link or a solicitor.

If a parking space is available on a public road, even if it's directly outside your house, anyone is allowed to park there. This can be frustrating, especially if spaces are hard to come by on your street, but it is not a matter for the police or the council.



WOBURN SANDS COMMUNITY MARKET DATES

SATURDAYS



A Community Market is held bi-monthly on the second Saturday from 10:00-14:00 February, April, June, August, October and December around the Institute and Memorial Green.

This is a market for locally produced food and crafts and is run by volunteers and some Councillors.



OVER 60's MONTHLY OUTING

In every month except January, February and November, the Woburn Sands Town Council along with Wavendon and Bow Brickhill parish councils organise and subsidise a coach trip to a great variety of places of interest.

These are usually held on the third Wednesday of the month and tickets booked via the relevant parish clerk.

For more information or to book contact:
l.stapleton@wstc.org.uk

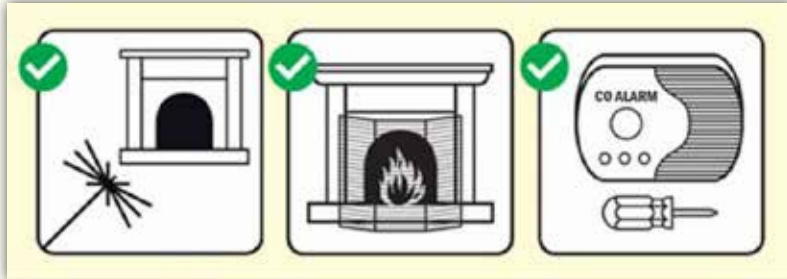

Twelve chimney fires since 1 January 2020 prompts safety reminder

With the weather set to provide us with colder evenings again for a few more weeks at least, firefighters are urging people who have open fires or stoves to take care, and ensure their chimney is in good condition, and is regularly swept.

During the 2018/19 financial year 69 chimney fires were attended in Buckinghamshire and Milton Keynes. So far this year there have been 37 since 1 April 2019, and 12 of these took place in January 2020, with crews attending fires in Little Brickhill, Bletchley, Stewkley amongst others.

Joanne Cook, head of Buckinghamshire Fire & Rescue Service's community safety team, said: "Now that we are in the colder part of the year, those with open fires are more likely to use them.

A blocked or defective chimney can cause carbon monoxide poisoning as well as a fire, so regular inspection and cleaning of chimney flues can help to identify and eliminate issues before they become a problem.

Make sure your chimney is swept regularly by a certified chimney sweep. The recommended frequencies depend upon the fuel you burn, and we have included a guide below, but if you have any concerns or are unsure your Chimney Sweep will be able to advise you.

It is also really important to have working smoke alarms in your home and that you test them once a month. If you are using an open fire or stove it is also advisable to invest in a carbon monoxide detector, as early warning can make the difference."

RECOMMENDED FREQUENCIES ARE:

- .. Smokeless coal - at least once a year
- .. Wood - up to four times a year
- .. Bituminous coal - twice a year
- .. Oil or gas - once a year

The following websites can help you find a certified chimney sweep:

- .. National Association of Chimney Sweeps - nacs.org.uk
- .. Guild of Master Chimney Sweeps - guildofmasterchimneysweeps.co.uk
- .. Institute of Chimney Sweeps - instituteofchimneysweeps.com
- .. Heating Equipment Testing and Approvals Scheme - hetas.co.uk

JO'S TOP TIPS FOR SAFER CHIMNEYS

- .. Always use a fire guard to protect against flying sparks from hot embers.
- .. Make sure embers are properly put out before you go to bed.
- .. Keep chimneys and flues clean and well maintained.
- .. If you have recently opened up or about to start to use a fireplace, make sure it is inspected by a qualified person.
- .. When burning wood, use dry, seasoned woods only.
- .. Never burn cardboard boxes or waste paper.
- .. Inspect your chimney breast, particularly in the roof space.
- .. Make sure that it is sound and that the sparks or fumes cannot escape through cracks or broken bricks.
- .. Ensure wood burners are installed and maintained in accordance with the manufacturer's instructions.
- .. Make sure the appliance receives enough air to allow the fuel to burn properly.
- .. Consider fitting a carbon monoxide detector.

News from Greensand Country Landscape Partnership

2020 Festival will celebrate Greensand Country landscape and its connection to communities.

The Greensand Country Festival 2020 is the third annual event organised by the Greensand Country Landscape Partnership, which includes a wide variety of events and activities provided by partners, local business, special interest groups and visitor attractions.

Taking place across the landscape, from Leighton Buzzard to Gamlingay, throughout May, the festival is a celebration of the distinct, beautiful and loved Greensand Country, and helps to encourage those living within the area to get out and explore the outstanding countryside on their doorstep.

The festival will showcase a diverse and exciting programme of events and activities, with something to suit every interest, from forest bathing, animal workshops and guided walks, to trail running, horse-riding and children's activities.

Claire Poulton, Programme Manager at the Greensand Country Landscape Partnership explains: *"We are very proud to have established such a successful and popular Greensand Country Festival over the past two years. We are now in the final year of the National Lottery Heritage Fund programme; and are keen to ensure that the positive changes and additions that we have made to this special landscape, continue into the future. Our lead organisations, Bedfordshire Rural Communities Charity and The Greensand Trust are committed to the continued delivery of the Greensand Country Festival, and I can't wait to see how it will continue to evolve."*

Gill Welham, Chief Executive of The Greensand Trust, says: *"We have been overwhelmed by the fantastic response to the Greensand Country Festival and once again have more than 200 events taking place across the landscape in May 2020. As the co-lead of the Greensand Country Landscape Partnership, we look forward to shaping the future of this fantastic community events programme."* For further information about the Greensand Country Landscape Partnership visit www.greensandcountry.com and for regular updates

follow @greensandsocial on Facebook, Twitter and Instagram.

ENDS

About Greensand Country Landscape Partnership

Greensand Country is an island of distinctive, beautiful and loved countryside, based on a band of higher ground stretching from Leighton Buzzard to Gamlingay, rising out of the surrounding clay vales.

It contains all of Bedfordshire's remaining heathland, more than half of its woodland, and more surviving historic parkland than any other landscape in the country, all crossed by networks of cycle tracks and footpaths just waiting to be discovered.

The vision is that by 2020 Greensand Country will become a living and working landscape that is cherished by present and future generations and we will have reversed the gradual decline in the area's landscape character.

We are working towards creating a strong community led partnership and strategic framework to promote the area's interests and to secure the necessary investment to sustain the area's distinctive local charm, natural character and built heritage.

The Greensand Country Landscape Partnership is thrilled to have gained funding from the Heritage Lottery Fund to deliver a Landscape Partnership programme with an array of exciting projects which will help us raise awareness of the heritage value of Greensand Country and to reverse the gradual decline in the distinct landscape character of this beautiful and loved place.

To request further information or an interview please contact Anne Walsh, Communications & Marketing Officer at Greensand Country Landscape Partnership on 01234 838774 or email anne@greensandcountry.com.



Become a Greensand Country Charter Member

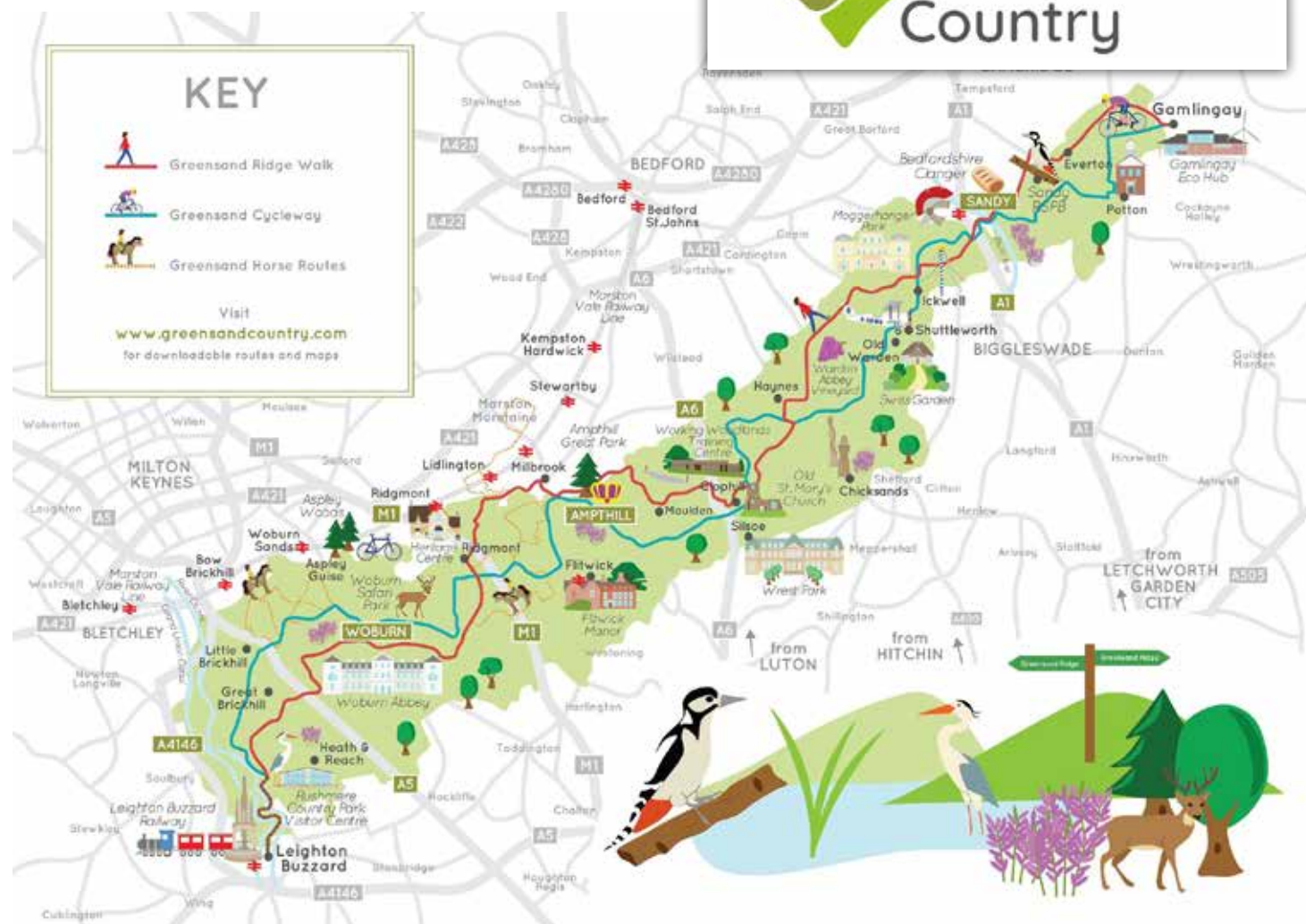

Are you a business based in Greensand Country, the distinctive, beautiful and loved countryside from Leighton Buzzard to Woburn Sands to Gamlingay! The Greensand Country Landscape Partnership needs your help to put this special place on the map as a recognised visitor destination.

Displaying the logo is just one of the many ways that you can show that you are 'Proud to be a part of Greensand Country,' helping to promote our shared landscape for the benefit of everyone; communities, businesses, organisations and visitors. Find out more

and sign the Charter at www.greensandcountry.com/caring-for-greensand-country/charter

Village Signs

The village signs are now in places across the Greensand Country.

Fifteen villages have signs. Each village has more than one entrance. 48 entrances have signs and as there are villages with signs each side of the road there are 55 signs. Our thanks go to Central Bedfordshire Council and the Greensand Trust for their support with the implementation of this project.



Reporting Issues to *Milton Keynes Council*

Issues that need to be reported to Milton Keynes Council can be done via the link noted below. This covers reporting items such as street lamps, waste and recycling, missed collections, defect on roads/potholes etc.

www.milton-keynes.gov.uk/pay-report-apply/report-it



Join us at
St Mary's Church

Coffee Morning
Every THURSDAY
9.45 - 1.00

Home-baked cakes &
proper coffee

Mothering Sunday



Sunday 22nd March
9.30 am

A celebration of all carers
Everyone welcome



**We walk around development
areas close to Wavendon,
stopping at several points
to pray for current and
future residents.
COME AND JOIN US!**

Meet at St Mary's Church
2.30pm Sunday, March 15th

*Please check church notices for
any changes and for future dates*

**rock
solid**



Where? We meet at Christ the King,
Kent's Hill

Who? For ages 9-14

When? Fortnightly on Thursdays 7.00pm-
8.30pm, alternating with Youth Club

Why? To learn about Jesus through
games, activities and chat

Where? We meet at Christ the King,
Kent's Hill

Who? For ages 9-14

When? Fortnightly on Thursdays 7.00pm-
9.00pm, alternating with Rock Solid

Why? To make friends and chill!

Dates for Spring 2020:

5th March, 19th March, 2nd April;
(Break) 23rd April, 7th May, 21st May

Dates for Spring 2020:

12th March, 26th March; (Break)
30th April, 14th May; (Break)