

Wafas A N D Wallas

YOUR LOCAL PARISH MAGAZINE

www.wavendonparishcouncil.co.uk

March 2022

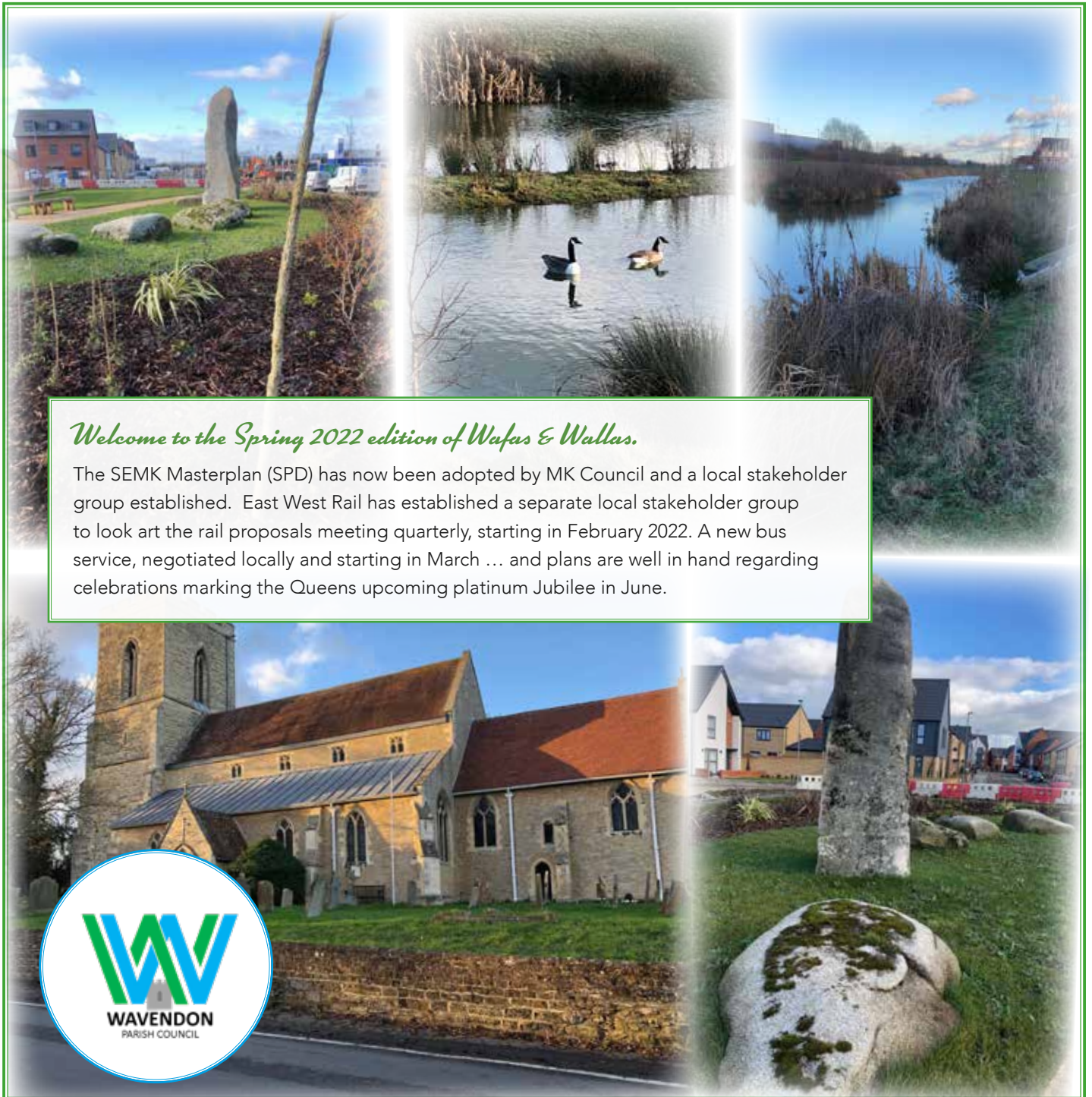

Wafas & Wallas - Your Parish Newsletter
Spring 2022 Edition



Wafas & Wallas – Your Parish Newsletter Spring 2022 Edition

Editor: David Hopkins

80 Walton Road | Wavendon | Miton Keynes | MK17 8LW

For any local issues contact me at: David.hopkins@milton-keynes.gov.uk

Wavendon on the Web: www.wavendonparishcouncil.co.uk

Wafas AND **Wallas**

*Printed & Published by
Wavendon Parish Council on
behalf of the people of the
ancient Parish of Wavendon
(including parts of
Hog Sty End)*

Village Contacts Wavendon Parish Council

Cllr David Hopkins *(Chairman)*

Cllr Arthur Braddish

Cllr John Goss

Cllr Robert Hill *(Vice Chairman)*

Cllr Ron Jamieson

Cllr Marlese Levermore

Cllr David Ostler

**Copy Date
for June**

(the Summer 2022) edition:
Sunday 15 May



Wavendon Parish Council

For any issues that you would like to raise with Wavendon Parish Council please contact, in the first instance, Parish Clerk - **Alan Kemp**

Wavendon Parish Council Clerk
clerk@wavendonparishcouncil.co.uk

Address

57 West End, Long Whatton,
Loughborough, Leicestershire, LE12 5DW.

Phone Contact

HOME 01509 844241

MOBILE 07783 939020



WOBURN SANDS COMMUNITY MARKET DATES

Woburn Sands very own Community Market is held on the **second Saturday of the month from 10am - 2pm**, at the Memorial Green on the High Street.
(*look out for signs confirming market days during the pandemic).

This is a market for locally produced food and crafts and is run by volunteers and some local Councillors.

Looking to hire the Wavendon Community Centre?



Contact **Susan Hopkins** Hall Manager:

T: 07512 685198

E: sueanne.hopkins@gmail.com

Wafas & Wallas is produced by

bespokemedia
design - print - distribution

t 01234 720105 m 07879 403 538

www.bespokemedia.org

Reporting Issues to *Milton Keynes Council*

Issues that need to be reported to Milton Keynes Council can be done via the link noted below. This covers reporting items such as street lamps, waste and recycling, missed collections, defect on roads/potholes etc.



www.milton-keynes.gov.uk/pay-report-apply/report-it

From the Chairman of the Parish Council

Dear Residents,

DEFIBRILLATORS

A recent, thankfully very successful use of a defib device in Woburn Sands has highlighted the need to hasten the installation of additional devices across the Parish.



SEMK and EWR

Cllr Peter Marland (leader of MK Council) has approved (via a Delegated Decision) the revised SEMK Masterplan on Tuesday 11 January following amendments resulting from the call in's.

A separate delegated decision regarding the style of the eventual connection linking SEMK with the Newport Road took place on 25th January. It is now anticipated that the EWR Statutory Consultation will take place over the late summer 2022. *More on both these issues elsewhere in this edition of Wafas.*

CLIMATE CHANGE FORUM

The local (five parishes) climate forum is working with the MK Community Energy team with a view to share an initiative trialled elsewhere across MK aimed at building community efficacy around home insulation in the Danesborough towns and villages. It is planned to conceive of this in terms of a 'southern seam' linking of the parishes of Wavendon, Woburn Sands, Bow Brickhill, Little Brickhill and Great Brickhill, and volunteers in each parish have been invited to participate.

Don't forget to complete and return the Climate Change Group community survey asap and help shape our future (extra copies of the survey are available from myself or from the Woburn Sands Library or you can download from the Woburn Sands Town Council web-site)

FREE TREES



Tree Appeal provides free saplings of native broad leaf trees along with canes and spirals, mostly to schools but also to environmental organisations and nature projects. They are paid for by our sponsors so there is absolutely no cost to receive them. (But you have to plant them - we don't do that!). This is our sixteenth year and we have supplied more than 520,000 free trees in that time.

Wavendon Parish Council has a number of ongoing projects planned that could use some free trees? The suppliers have corporate sponsors throughout the country and thousands of high quality saplings to find homes for. If you could use some in your local area then please submit an application and the Parish Council will do its very best to help.

There is a list of the species we currently have available here:

https://www.treeappeal.com/tree_types.html

The planting season lasts until April and then we begin again in the autumn.

Tree Appeal.com Ltd, Enterprise House, Harmire Enterprise Park, Barnard Castle DL12 8XT

COACH TRIPS

In every month except January, February and November, the Town Council along with Wavendon and Bow Brickhill parish councils organises and subsidises a coach trip to a great variety of places of interest. These are usually held on the third Wednesday of the month and tickets booked via the relevant parish clerk.



THE NEW PAVILION (WAVENDON HUB)

off Dankworth Way and Stockwell Lane

Good progress is being made on the construction of the building with a view to a handover to the Wavendon Parish Council in June 2022. There have been some limited delays in the setting of the pitches, but it is anticipated that (given good weather this summer) they may still be playable from September 2022

REPORT IT ..

Report an issue to MK Council at:
<https://www.milton-keynes.gov.uk/pay-report-apply/report-it>

Information from your Parish Council
<https://www.wavendonparishcouncil.co.uk/>

Cllr David Hopkins Chairman

Wavendon Parish Council
David.hopkins@milton-keynes.gov.uk

Starship Robots in Woburn Sands

Starship Technologies had to hastily withdraw their robot delivery vehicles from Woburn Sands as soon as they realised they had failed to undertake the start-up procedures agreed with Milton Keynes Council regarding extending the scope of their delivery network.

Starship offered sincere apologies for the launch in the areas without first engaging with MKC and the local community. They blamed this on recent staff changes.

The process MK Council uses to adopt / launch in areas is via a 'protocol/ MOU' the council and Starship Technologies established which requires the process mentioned above along with an agreement on service coverage to ensure the types of incidents that local residents reported to Starship (blocking crossing points/operating on narrow paths etc) are minimised and there is an identified local benefit – for example, it reduces delivery vehicles and operates as a service required by the community.

Starship Technologies are keen to follow the agreed procedures and have started this engagement with a meeting with Woburn Sands Town Council in February.

If you would like to be in contact with Starship contact Lisa Johnson - UK Director of Public Affairs (Starship Technologies) at
e: lisa.johnson@starship.co
or at the website
www.starship.xyz



New Woburn Sands & Wavendon Bus Service



Britannia has now registered its 450 service, with an anticipated start date of 14th March 2022.

Timetable information can be found at:
<http://www.britanniabus.co.uk/en-gb/travel/timetables/midlands/450.html>

Fares information will be released shortly, but to confirm that council passes will be accepted throughout.

One question I am being asked regularly is where it will start and pick up from as well as from outside The Swan PH. Britannia feel it might well be possible to extend that elsewhere in the town if this proves necessary and they are happy to look at options.

The future of the service is really in the hands of the residents- if people use it then Britannia will add more journeys to it and as I know residents realise, if people do not use it then it makes it 'challenging' to keep it running. Britannia feel the route has the potential to become a full time service, but they must be cautious and expand it incrementally.

Please do let Derek know if you have any questions or suggestions.

Derek S. Taylor
Director (Britannia Bus)

passenger.services@britanniabus.co.uk
<http://www.britanniabus.co.uk/en-gb/>
tel: 08445 000131



Update on Allotments in Glebe and Eagle Farm developments

There are three sites that have been allocated for allotments within the new development areas in Wavendon. One in Glebe Farm and two in Eagle Farm.

The first site to be managed by Wavendon Parish Council is in Glebe Farm.

Details of the site location is below.



The most realistic date when this site will be handed over to Wavendon Parish Council is December 2022, but efforts are being made to establish if an earlier handover date can be achieved.

Work has started and soil samples have been taken. Quotations are being sought to replace any soil, supply of water to the site and any other required work. A planning application will have to be completed and approved by Milton Keynes Council before any required work can commence.

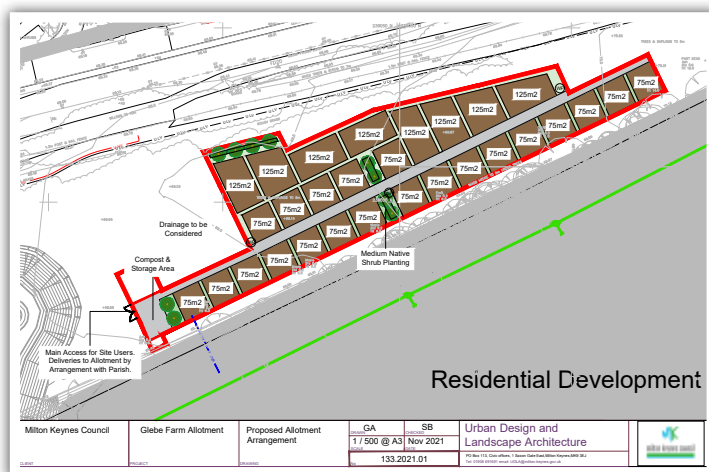

There is room on the site for twenty-nine plots, 21 x 75m² and 8 x 125m² and a draft plan is above.

Currently there are thirty-six people who have expressed an interest in renting an allotment across both Glebe and Eagle Farm. Milton Keynes Council are making efforts to establish from the Developers when the two other sites will become available.

A waiting list has been compiled by Wavendon Parish Council by date of request by people interested in taking on the rental of an allotment.

For further information please contact the Clerk to Wavendon Parish Council, Alan Kemp via email clerk@wavendonparishcouncil.co.uk

A progress update will be provided in the next edition of the Parish Newsletter.

East West Rail Consultation Update

Whatever happened to the promised feedback following the first consultation? An update from EWR ...

People living in towns and villages across the potential EWR Route, and their community representatives were extremely generous in their time and expertise during the 2021 Consultation, giving EWR a significant – and very welcome – challenge to see how and where we could change and improve East West Rail.

We received over 9,000 responses and, within these, over 160,000 individual matters were raised.

All of these responses are being reviewed and considered by our expert team.

We have a duty to take all of this feedback into real consideration – which takes time – and will publish a report summarising the consultation feedback as well as information on how the feedback has been used to inform plans for the railway once we've completed that work.

We are pushing ourselves to develop the best possible design options based on this feedback alongside environmental, technical and financial studies.

It is not just a case of the total volume of feedback either. Among the thousands of comments and ideas we received in the 2021 consultation, people asked us to re-think how embankments might impact the landscape, to minimise noise coming from a new railway, and gave us helpful detail about which rights of way really make a difference to people living in small communities. These are just a few examples of the detailed issues that our team are reviewing, assessing and evaluating in depth. This will enable EWR Co to provide individual responses to each matter as well as more general responses to any recurring themes.

Initially we had aimed to finish this work early in 2022, but we now believe it is more likely to be ready to publish in the summer of 2022. Communities will have further opportunities to comment on EWR proposals at a subsequent statutory consultation,



following which we expect to submit a formal application for a Development Consent Order to the Secretary of State for permission to construct and operate EWR.

About the East West Rail project

East West Rail intends to create a new direct connection between Oxford and Cambridge. Serving communities across the area, it intends to bring faster journey times and lower transport costs as well as ease pressure on local roads.

East West Rail is planned to be delivered in three Connection Stages:

•Connection Stage One:

Oxford to Bletchley and Milton Keynes

•Connection Stage Two:

Oxford to Bedford

•Connection Stage Three:

Oxford to Cambridge

Network Rail was responsible for developing the first part of the East West Rail, connecting Oxford with Bicester, and is a partner in a construction alliance to deliver Connection Stage 1 of the project, where East West Railway Company (EWR Co) and Network Rail are acting as the Department for Transport's joint sponsors. EWR Co is now developing the route to enable services to run to Cambridge via Bedford and plans to seek statutory powers under the Planning Act 2008, following a period of extensive consultation.

East West Rail Company Stakeholder Meeting

East West Railway Company (EWR Co) has invited community representatives from every parish, ward and electoral division along the potential route of East West Rail to join regular discussions about the much-needed new transport connection. These include Wavendon Parish Council and Woburn Sands Town Council – plus local Danesborough & Walton ward representatives.

The groups, which will continue throughout the planning, building and running of the new railway, are being set up at this early stage so the project can improve and benefit from collaboration with communities, who will see a greener, quicker and more affordable way to travel across the region.

Almost 350 Ward and County Councillors and over 200 Town and Parish Councils between Oxford and Cambridge have been invited to represent their local communities at these groups. There will be 17 location-specific discussion groups in total along the East West Rail route with meetings set to take place every three months.

Simon Blanchflower CBE, Chief Executive at East West Railway Company said:

"The right transport will open up so many opportunities for people – maybe they're thinking about applying for a new job, moving to a new home, or just seeing more of what this beautiful region has to offer. I'm delighted to see these groups being set up: we're indebted to community representatives who take the time to share their thoughts and experience with us, so we have as much information as possible to create what they and their neighbours need."

"These groups offer an opportunity for local representatives to have honest discussions with our team at regular intervals, during and outside of formal consultations. Most importantly, it will give our team the chance to really listen to the things that are important to local communities. We know issues such as rights of way, embankments and their impact on the landscape, and how we might minimise any noise that could come from the new railway are really critical and we'll keep listening and working with local representatives to make sure any disruption to their communities is justified and kept to a minimum."



The first meetings will be held during February 2022. Initial meetings will be held virtually and will shape the terms of reference for the groups and consider key local topics for future discussions. It is likely that the lifting of Covid restrictions will allow face-to-face meetings to take place at locations along the EWR route in the future if people feel comfortable doing so.

Communities can check who is representing them locally by visiting our website. Alternatively, people can write to the EWR Co team at Contact@eastwestrail.co.uk for more information.

Once the first meetings have taken place, agendas, minutes and presentation materials will be available in a new space on the East West Rail Community Hub.

EWR Co will publish plans for wider community engagement in the near future.

Go to (for more details)
**[https://eastwestrail.co.uk/library/
local-group-maps](https://eastwestrail.co.uk/library/local-group-maps)**





The Parks Trust
MILTON KEYNES

Victoria Miles has been appointed by The Parks Trust to take over as **Chief Executive** when David leaves in the summer. Victoria is currently Chief Executive of The Northamptonshire Community Foundation and is leaving after fifteen successful years with this charity. Victoria was recently awarded an MBE in the New Year's Honours List in recognition for services to the community in Northamptonshire during Covid-19.



The Parks Trust was formed as an independent charity in 1992 to care for parks and green spaces in Milton Keynes. Retiring CEO, David Foster took over from the Trust's first Chief Executive, Brian Salter, in 2003. Under David's leadership it has grown significantly both in terms of what it does, the scale of parks and landscapes and also financially. The Trust's endowment fund, which generates most of its income, is now valued at £129m and includes a national property portfolio valued at £89m.

The Trust has continued to break new ground and pioneer new ways of managing public open space, going against the national trend of a steady decline in investment in public parks. The Parks Trust achieves high standards of care and maintenance and last year a survey of residents in Milton Keynes showed that 94% think it does a good job and a staggering 97% consider the parks are well maintained.

Today, The Trust manages over 6,000 acres of parkland and green space in Milton Keynes, employs 75 permanent members of staff and has an annual turnover of £10m.



An update on Marshalls Proposed relocation to Cranfield Airport

As you are aware Marshall announced in 2019 that it was considering Cranfield Airport as the potential new home for our Cambridge-based aerospace business, along with Duxford and RAF Wyton. In October 2020 we confirmed that we had signed an Option Agreement with Cranfield University for an area of land at the Cranfield Airport site. After discounting Duxford and RAF Wyton for various reasons, we announced in October 2021 that our relocation plans remained firmly on track and that we intended to submit an Outline Planning Application for the Cranfield Airport site during Autumn 2022. Whilst this doesn't mean a final decision has been taken, **Cranfield represents a very compelling option for the future location of our aerospace business.**

With activity underway to pull together the detailed information that we will need to submit as part of the Outline Planning Application later this year, we recognise the importance of engaging with, and listening to, local communities and local groups as we move forward.

Our intention is to run a public consultation process during March or April to present our plans in more detail and give local people the opportunity to review our plans and engage with us.

Katherine Williams

Head of Public Affairs

Katherine.Williams@marshalladg.com

Tel: +44 7795 497022





Bedford to Bletchley Rail Services

Train services resumed on the Marston Vale Line (Bedford – Bletchley) from February 14th 2022.

Services will run to the same timetable as introduced before Christmas - nine return journeys Monday to Saturday supplemented by a full rail replacement bus service at other times.

The timetable can be downloaded here <https://www.marstonvalecommunityrail.org.uk/>

It is planned to gradually increase the number of train services over the spring starting with additional peak-time services.

Passengers travelling by rail replacement bus should buy tickets from any staffed station or the ticket vending machines at unstaffed stations before travel.

Stephen Sleight, Marston Vale community rail partnership officer, said: "I am pleased to welcome passengers back to the Marston Vale Line next week after a time without rail services.

"Our line provides a vital link for the communities along it in accessing work, education and retail. It offers a wide range of opportunities for great days out too including Ridgmont Station Heritage Centre and Bletchley Park.

"We also have an exciting new Symbol Spot trail – collect your free pack when purchasing tickets at Bedford, Bletchley or Milton Keynes Central Stations or when visiting Ridgmont Station Heritage Centre with a valid ticket."

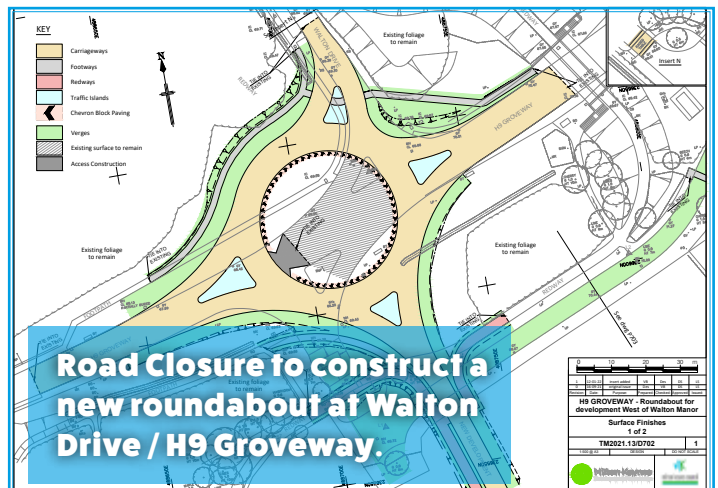

The design work for the new access roundabout to the OU is almost complete and MKC has started on some site clearance works, followed a few weeks later with the main works. Above is a copy of the plans showing general arrangement of the proposed new roundabout for information.

The work will be done in 2 phases and will be carried out by the MK Council service provider, Ringway.

Phase 1 February 2022 (2-3 weeks subject to weather)

- Tree stump, root, and overgrowth removal in grassed areas either side of the H9

To carry out this work safely and efficiently it will be necessary to temporarily close the slip lane off the H9 Groveway into Walton Drive to through traffic for the duration of the works. Access from Walton Drive onto the H9 will be maintained.

The Open University has kindly offered to keep open their gated barrier on Walton Drive to allow access to their car parks, Walton Pre-preparatory School and Nursery and residents.

Signage will be in place to advise of lane closures and diversion routes for vehicles.

Access to The COVID vaccination centre will be maintained via the signed diversion route.

Phase 2

MK Council will be constructing the new roundabout from April to October 2022

The Council apologise in advance for any inconvenience these works may cause to the area and will do our best to keep any disruption to a minimum.

*For further information please do not hesitate to contact **Diljeet Singh** - Project Engineer
Diljeet.Singh@milton-keynes.gov.uk*

Milton Keynes Council | Environmental & Property | Highways | Synergy Park | Chesney Wold | Bleak Hall | Milton Keynes | MK6 1LY – tel: 07533 412682

Milton Keynes' First Fossil-Free School!

Exciting things have been happening at Glebe Farm School, Wavendon. We are extremely proud to be Milton Keynes Council's first fossil-free new build school with sustainability at the heart of all we do from solar panels to power much of the school including electric Bunsen Burners to planting trees and offsetting 12.43 tonnes of CO2 eq.

Introducing our new logo

Did you know that 'glebe' – means cultivable land and fields?

We have featured ploughed farmland under a sunrise to reflect this, the design represents growth, new beginnings and positivity.

The illustration forms the shape of a capital letter G.



Being your child's cheerleader – The vision at Glebe Farm School.



Our vision is to deliver an exceptional 21st century, comprehensive and universal all-through learning experience that will unlock every individual's potential.

- We will value the way in which each child is unique; celebrating diversity and valuing the importance of each other within our community.
- We will demonstrate the highest standards of respect and empathy of others regardless of ability, gender, ethnicity or religion.
- We will uphold high expectations around behaviour, nurtured in a high-trust environment which will promote independence.
- We will be relentless in our endeavours to build secure relationships with each other based on mutual respect.
- We are here for all children, and all learning needs, and will provide personalised support whilst never compromising on raising aspirations for every learner

ORDINARY PEOPLE DOING
EXTRAORDINARY THINGS!



Have you considered being a school governor?

You don't need any specific skills or experience to be a school governor. You must be over 18, but you don't need to be a parent or have experience working in education. Often, it's the outside experience you can bring that a school needs.

Professional experience in areas such as HR, finance, legal, health and safety or project management are all useful to a school. Soft skills such as leadership, communication and problem solving are also great additions. Above all, we need people who have the desire and can commit the time to make our schools wonderful places and nurture a secure and engaging environment in which we all thrive.

If you are interested in becoming a school governor at Glebe Farm School email Stephanie Boak at: sboak@iftl.co.uk

For more photos, updates and to contact us visit www.glebefarmschool.co.uk



Staff and pupils at St Mary's Wavendon CE Primary School are delighted to share such a positive story about one courageous pupil.

Emily simply wanted to "help all those people who don't have hair because of cancer to be able to get hair and make them feel a bit better" (Emily's words). She said it was something she could actually do herself, and told her parents for a while that she had wanted to do this. Emily bravely went to the hairdresser who washed her hair, dried it and divided it into sections with hairbands and cut it. It was then posted to the Little Princess Trust.

Free after-school clubs for families thanks to Council boost

Milton Keynes Council is launching a new scheme to help local organisations put on free or low cost after-school clubs and meals for children, reaching families who may be struggling to make ends meet.

Organisations who set up **'Homework Plus Clubs'** can apply for a **one-off grant of £1,000** from the Council. To qualify, clubs should be free or low cost and open to all children. As well as providing support



So far Emily has raised £225, with one wig costing £550. Emily hopes that by talking about this it will lead others to support such a worthwhile cause by spreading their love and kindness, to offer hope to many who may not be so fortunate, or who are in need at this difficult time.

Mrs Dicks, headteacher, said *'We are very proud that Emily is able to model our distinctively Christian values in such a positive and unselfish way, and know that others within our school community and beyond support her in this act of kindness.'*

To show your support and learn more about Emily's venture, please follow the link below:

Emily Cronwright is fundraising for Little Princess Trust (justgiving.com)



with homework including internet access, organisers should offer a substantial meal. The scheme is one of many recent Council initiatives designed to help families who may be struggling financially following rises in the cost of living.

Last year, the Council's Poverty Commission found almost 23,000 children were living in poverty in Milton Keynes.

The Council is working with local partners on a range of initiatives to challenge child poverty, including:

- A childcare deposit scheme to support parents and carers who want to work, but who struggle with upfront childcare costs.
- A low-cost school uniform scheme.
- Working with partners SOFEA, Community Fridge and Foodbank Xtra on community food larders.

Interested organisations should apply using a simple two-page form which includes full conditions. Applications should be sent to HAF@milton-keynes.gov.uk by **11 March 2022**.



Join our Dinosaur Safari!

MK Council's popular **free-to-play Love Exploring app** which encourages children and young people to get active and explore their local area has reintroduced dinosaurs to Milton Keynes.

Love Exploring uses 'augmented reality' graphics that display on smartphones as you walk around. More than 5,000 children and their families have taken to local parks and streets since the launch in October last year.

An update for the game, Dinosaur Safari, is now available to download and play in time for the Easter break <https://loveexploring.co.uk/>.

The clever technology brings prehistoric creatures to MK's woodlands, parks and streets, with more than 20km of specially designed trails over a dozen different locations.





BE PART OF



**THE BIG
CLIMATE
FIGHTBACK**



In association with the Woodland Trust, we're planting more than 500 trees as part of "The Big Climate Fightback" and "The Queen's Green Canopy". Come along to the brand new Wavendon Heights Community Playing Fields off Stockwell Lane, Wavendon, MK17 8ZN on either Friday 8th or Sunday 10th April between 11am & 2pm and be a part of

**TREE
CHEERS FOR
WAVENDON**

Help make this amazing new open space even better, fight climate change, and get involved with your community!

All you'll need is a spade and enthusiasm! Follow this link for tree planting guide:-

<https://www.woodlandtrust.org.uk/plant-trees/advice/how-to-plant/>

LOOKING FORWARD TO SEEING YOU.

E. WavendonConnect@WavendonParishCouncil.co.uk



Are you aged 5-18 and from Woburn Sands or the surrounding area? Are you concerned about the Environment?

WOBURN SANDS TOWN COUNCIL

YOUNG ENVIRONMENTALIST AWARDS 2022

Step 1

What can I do to help the Environment?

Think of a good idea that can help the environment, it needn't be too big, just something you can do.

Step 2

How will I do it?

When you have decided what you want to do and how long it is going to take – have a think about how you will report on your activity.

Step 3

What about evidence?

Photos, drawings or recordings would be great evidence of your activity as a Young Environmentalist.

Step 4

Fill in the entry form

Apply to become a Woburn Sands Young Environmentalist by filling in the entry form and submitting your evidence.

Step 5

Become a Woburn Sands Young Environmentalist!

All competition entries receive a certificate. Prizes for the winners.

Look on our website

For more ideas about starting your quest and to download an Entry Form:

www.woburnsands.org.uk

Or contact Alison Jordan, Town Clerk: a.jordan@wstc.org.uk or 01908 585368

Rotary  **Woburn Sands & District**

Invite you to

AN EVENING AT THE RACES

Friday, 25th March 2022 - 7pm



Tote Bets
ONLY £1
per horse

Join us at...

The Summerlin Centre

138 Station Rd, Woburn Sands, MK17 8SG

In aid of

Rotary charities including 'Emergency Shelter Boxes', plus local 'Shay's Smiles' & 'Milton Keynes Multiple Sclerosis Therapy'

Sponsor a race for a minimum of £25 and have your chosen name announced and displayed on the night.

Bring your own drinks

Cash only please the tote

Double or treble bets available on the final two races - grand prizes of £25

Be an Owner or Jockey for £2, and get the chance to win £7 if your horse comes in first

B Filmed Races

All losing tote betting slips will be entered into a raffle for a magnum of Prosecco at the end of the evening

Tickets Adults £12, under 16's £6 - Refreshments included

Tickets available from Woburn Sands Rotary - sueleigh55@btinternet.com or - lfgsutton@aol.com

Have Fun!

LOL

LOL



The perfect way for girls aged 5-11 to get involved with football

TIME AND DATE

STARTS SUNDAY 11th March 2022, 10.30AM & THEN EVERY SUNDAY

LOCATION

Fulbrook Middle School, Weathercock Lane, Woburn Sands, MK17 8NP

NEXT STEPS

Head to thefc.com/WootobixWildcats & book on the Fulbrook MS sessions or for more info contact us via: Wildcats@wfc.co.uk



Queens Platinum Jubilee Celebrations 2022

Wavendon Parish council have set up a subcommittee under the Chairmanship of Cllr Marlese Livermore to come forward with plans to enable the Parish to celebrate the Jubilee, bringing new residents together and furthering the already amazing community spirit engendered over time and reinforced by the work of St Mary's church and St Mary's school in recent times.

Ideas have been explored and the proposals currently are.

Thursday 2nd June

The Wavendon volunteer army are organizing with the help of Cllr Arthur Braddish a **Beacon to be lit on land adjacent to the recreation ground at 9.30pm** to coincide with the lighting of similar beacons across the four home nations. Residents are asked to gather



on the rec to watch and support the event. If anyone has ideas on how to build on the occasion and is willing to implement them then please contact the clerk. Volunteers needed. It is hoped to have some form of paid for refreshments available . burgers/ sausages....hot coffee and chocolate a beer tent.

In the afternoon [2.30/4.30pm] St Marys will host a **cream tea** in the Rectory garden to kick off the weekend. It is hoped to organize a cake baking competition for all parishioners including children to be judged at that event

Friday 3rd June

Residents are asked to organize their own tea parties/street parties. There will be such a gathering on the recreation ground at 2.30pm and events are planned for Cross End residents and across the new communities. Details will be provided by local residents groups to their neighbours. All are invited to bring their chairs, tables and food to the rec and meet up with friends old and new or to attend their more local events, with their own food etc..Please make a diary note. Any ideas for music or other entertainment gratefully received. We have no funds as all events are free. Perhaps some games for the children...hoopla and other village fete type attractions.



Saturday 4th June

It is intended to organize some sports and games for the whole village. Wavendon and Woburn lions football club are planning two mini events during the morning.... 5 teams under 8 girls and 5 teams under 6 mixed for those just starting out. Details will be on their web site. Ideas are needed for some events in the afternoon.

Sunday 5th June

St Mary's church will hold a special service to commemorate the Jubilee at 3pm. Details on the church web site. All are very welcome to celebrate Her Majesty's long service to this country.

Volunteers are needed to organize a treasure hunt for the children of the parish and to organize a walk around the village highlighting its history, interesting buildings and famous people. That walk could also explore the many footpaths, fields and hedgerows throughout the parish. Perhaps a dog show/walk to get our growing number of dog owners to know each other...ideas/volunteers needed. Perhaps starting on the rec at 2.30pm on Saturday.

It is intended to produce a celebratory edition of Waffas and Wallas and also a video/film record for our young people to remind them of this historic event. The WVA will also be planting a suitable oak tree in celebration of the event. **Volunteers are needed to help plant some hundred or more trees on the new playing field.**

Subject to grants and funds being available the PC are hoping to provide Jubilee mugs for the St Marys School children, bunting and flags and a purpose built gas beacon for this and future events.

Please contact

CllrMarleseLivermore@

Wavendonparishcouncil.co.uk or

clerk@wavendonparishcouncil.co.uk

with ideas, offers of support comments or for more details.



Development of SE Milton Keynes and East West Rail

Over the last couple of years there have been a number of significant developments which will affect the community of Woburn Sands.

The two key initiatives are, first, the approval in PlanMK for the development of the land between Woburn Sands and Bow Brickhill; this is known as **SEMK**.

The second initiative is the approval by the Government to develop the Oxford-Cambridge railway (known as **East-West Rail or EWR**). There have been a wide number of publications about the proposals and a variety of consultations have been held although these have not involved many public meetings due to COVID. The Town Council has been involved in many of these discussions.

The time is now approaching when a number of key decisions will be made by the relevant authorities.

This article brings residents fully up to speed and gives details what will be happening in the next few months and how you can contribute.

In all the discussions the Town Council has been anxious to ensure that the long term economic and social health of the existing community is not put at risk by these proposals. The wider Woburn Sands community consists of about 9,000 residents many of whom live to the North of the railway line. About 35-40% of the residents live in Central Bedfordshire but regard the Woburn Sands High Street as their centre.

SEMK

SEMK consists of approximately 198 hectares, just over half of which lies within the parish of Woburn Sands; the balance lies within the parishes of

Bow Brickhill, Wavendon, and Walton. Under the provisions of PlanMK approximately 3,000 dwellings plus associated infrastructure are to be provided.

Milton Keynes Council is required to publish a **Supplementary Planning Document (SPD)** which sets out the overall shape of the site, its constituent parts, and how it will link into the existing infrastructure. A draft SPD was published in early 2021 for consultation. This draft was revised in the light of responses and a second/final draft was published by MKC for Delegated Approval by the Leader of MKC (Cllr Peter Marland) on 30 November 2021.

Following discussions between Cllr David Hopkins (acting on behalf of WS Town Council and Wavendon PC) and Cllr Marland a number of important modifications to the second draft were agreed at the November meeting and will be incorporated in the final version to be signed off in January 2022:

- MKC's official Council policy is that no further development of Milton Keynes will take place to the east of Newport Road until the 2040's at the earliest, and preferably later than this
- There will be only one road link between the SEMK development on to Newport Road and one on to Bow Brickhill Road. Those links will be local links (ie not grid roads) and weight limited. These links will be constructed at the same time in order to protect traffic flow through Woburn Sands
- The development will be phased from West to East and therefore will not reach the Woburn Sands/Wavendon area until about 2034. This reflects the fact that final decisions on the detailed layout in this area cannot be made until the arrangements for the railway crossing and station at Woburn Sands are agreed

Following that meeting the decision was **“called in”** by Cllr Hopkins (on behalf of WSTC and Wavendon PC) and Bow Brickhill PC on the grounds that **(a)** there was no overarching transport strategy (as had been promised in PlanMK), **(b)** the SPD should be delayed until the EWR plans had been agreed, and **(c)**, in the view of BB PC, the case for locating a Gypsy and Travellers’ Site in the South West of SEMK had not been justified. The “Call in” procedure creates a Scrutiny Committee which has the power to review the decision and report back to MKC.

Informal discussions between MKC officials and representatives from WSTC and BBPC prior to the scheduled meeting of the Scrutiny Committee were held. As a result of these MKC agreed on a number of procedural measures which will tighten up the relationship between EWR, MKC and WSTC in order to ensure better coordination. One of the measures specifies that the inclusion of an optional site for the relocation of the Woburn Sands station in the SPD should not imply that MKC will automatically agree to the relocation. MKC has also agreed to share all traffic data. Accordingly the scheduled meeting of the Scrutiny Committee was cancelled.

The final SPD will be signed off in early January 2022 and available on the MKC website.

East West Rail

EWR published their initial proposals for informal consultation in respect of Woburn Sands in early 2021; these included an option to close the railway crossing and construct a by-pass which would deliver all traffic into Woburn Sands via The Leys/Hardwick Road/Theydon Avenue. There was a large response from Woburn Sands residents objecting to this option; residents were also very concerned at the prospect of frequent closure of the existing crossing gates which was the alternative option suggested by EWR. It should be noted that some 60-65% of all traffic into and out of Woburn Sands currently uses the crossing.

Following the close of the consultation the Town Council has had a number of meetings with EWR. The Council has made clear that the preferred option is to build a road bridge either over or preferably under the railway. This would be very disruptive in the short term but would provide a robust long term solution. EWR are currently investigating this option and will report back early in 2022. They are also



considering the location of the station and how this would be affected.

EWR’s intention is to bring forward proposals in mid-2022 for formal consultation. The consultation process will be followed in due course by a submission to the Department for Transport; this submission will include the proposals for the whole stretch of the line between Milton Keynes and Cambridge (including a new stretch of line between Bedford and Cambridge). The submission will be accompanied by a detailed business case which will have to be signed off by the Treasury. If agreed by central government the Secretary of State will issue a Development Control Order (DCO). This order will supersede any MKC planning provisions which might be included in the SEMK SPD; hence the importance of ensuring close liaison between MKC and EWR in finalising the SPD.

Once the DCO is published it will be the subject of a Planning Inquiry when any interested party can make representations.

It is impossible to be specific on the timescale but realistically the Planning Inquiry is unlikely to happen before the end of 2023; mid/late 2024 seems more likely. Implementation would therefore start 2026/27. EWR have advised the Town Council that they plan to have the whole line operational by 2030.

The local Parish and Councils will issue regular bulletins to report progress as and when information becomes available. Subject to COVID restrictions public meetings will be held when possible.



We warmly invite you to join us at St Mary's Church - for worship on Sundays and for other regular events as well as special celebrations such as Easter. **Please check our website** for details, and for resources and support open to everyone and available at any time. All events and any changes or cancellations will appear on the website and on local social media and notice-boards: please check! **Revd Matt Trendall will gladly answer any enquiries: 01908 582839**

Find our online resources to watch at any time:
<https://www.stmaryswavendon.co.uk>

Monthly Online Exhibition

We're seeking contributors for future displays! New show **now** on website, with info on next topic

Daily inspiration

A fresh nugget of hope to uplift you each day

Join a group - adult bible study
weekly by **live** - children's (5-8, 9-14)
link (Zoom): - virtual church choir

Open Door Coffee Morning Thursdays ~ 10 am to 12 noon

All welcome for freshly-brewed coffee or tea, our delicious home-made cakes and a chance to meet or make friends
Every week in school term: closed in August

St Mary's Monthly Quiz Night

3rd Tuesday each month at 7.30pm
All welcome: any age. More info on website
Email Revd Matt for details of next meeting

Weekly Worship

Join our Simple Sunday Service in person at 9.30 (for now, please wear a mask to keep vulnerable people safe); or to worship from home, head to our website for a pre-recorded version to watch at any time.

For more info on all our activities, email Revd Matt:
matt.trendall.mk@gmail.com

Prayerchain For confidential support in prayer, whether urgent or ongoing, you can reach our dedicated church team by emailing us at any time on: **prayerchain.wavendon@gmail.com**

See our Facebook page: St Mary's Church Wavendon Village